

# 7mm Remington Magnum

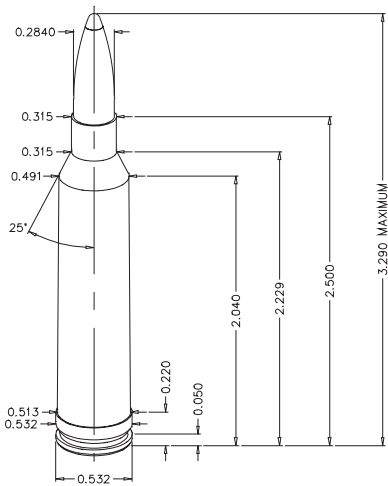

## Test Specifications/ Components

**Firearm Used:** Savage Model 116

**Barrel Length:** 26"

**Twist:** 1 x 9"

**Case:** Federal

**Trim-to Length:** 2.490"

**Primer:** Fed 215

## Remarks:

The history of U.S. ordnance is full of examples of good cartridges that have passed into obsolescence. The 219 Zipper, 284 Winchester and 6.5 Remington Magnum were all fine ideas, but terribly limited by the rifles for which they were introduced. Some, like the 244 and 280 Remington, have

survived after being reintroduced in different rifles or in slightly modified versions of the same gun. When Remington brought out their 7mm Magnum in 1962, however, they did everything right the first time. Introduced in what was then the new Model 700 bolt action, both rifle and cartridge have gone on to become phenomenally popular. Today, the 7mm Remington Magnum consistently ranks among the top ten most popular cartridges, based on reloading die sales.

Remington had only two real competitors in this market. One was the 7mm Weatherby Magnum, offered in Weatherby's rather expensive Mark V rifle. The other was the 7x61mm Sharpe & Hart, chambered in the infrequently encountered Shultz & Larsen. While the performance of all three is quite similar, only the Remington was readily available in an affordable package. The real secret to its success is quite simple—it's fast, flat, accurate and potent.

The 7mm Remington Magnum is, first and foremost, a hunting cartridge and has been used to take virtually every big game species in North America, including big bears. Realistically, it is probably at its best when used in long-range, open country hunting typical of western big game territory. While its primary use is in the hunting fields, the cartridge's flat trajectory and inherent accuracy has attracted the interest of competitive shooters as well. Eight years after its introduction, it was used in conjunction with Sierra's 168 grain MatchKing to win the prestigious 1000 yard Wimbledon match at Camp Perry. At this writing, the U.S. Secret Service countersniper teams are armed with custom-built 7mm Remington Magnums. Considering their stringent requirements for 1000 yard accuracy, this is quite a recommendation for the versatile 7mm Remington Magnum.

# 7mm Remington Magnum continued

**#1895 .284" 100 gr. HP**  
C.O.A.L. 3.150"



Powder↓/Velocity→	3300	3400	3500	3550	3600	3650	3700
IMR-4895	56.1	58.1	60.1				
IMR-4064	56.7	58.4	60.1	61.0	61.8		
760	60.5	63.1	65.7				
H414	60.9	62.9	64.9				
XMR-4350	65.6	66.9	68.2	68.9	69.5		
IMR-4350	64.9	66.4	67.9				
RE-19	67.1	68.8	70.5				
IMR-4831	67.8	69.3	70.8	71.6	72.3	73.1	73.8
XMR-3100	69.1	70.8	72.5				
H4831 SC	68.2	69.9	71.6				
RE-22	67.6	69.1	70.6	71.4			
<b>Energy/ft.lbs.</b>	<b>2418</b>	<b>2567</b>	<b>2720</b>	<b>2799</b>	<b>2878</b>	<b>2958</b>	<b>3040</b>

	Powder	Grains	Velocity	Ft. lbs.
Accuracy Load	IMR-4895	60.1	3500	2720
Hunting Load	XMR-4350	69.5	3600	2878



*A tired but happy Fred Gregory with his first elk. Fred dropped the bull at 230 yards with a single shot from his 7mm Remington Magnum after a long, hard stalk.*

*Fred Gregory's recovered 7mm 160 grain SBT, used to harvest the elk pictured above.*



**INDICATES MAXIMUM LOAD – USE CAUTION**  
**LOADS LESS THAN MINIMUM CHARGES SHOWN ARE NOT RECOMMENDED.**

# 7mm Remington Magnum continued

**#1900 .284" 120 gr. SPT**  
C.O.A.L. 3.250"



Powder ↓/Velocity →	3000	3100	3200	3300	3350	3400	3450	3500
IMR-3031	49.7	51.9	54.1					
IMR-4895	50.9	53.2	55.5	57.8				
IMR-4064	51.6	53.8	56.0	58.2				
IMR-4320	53.6	55.7	57.8	59.9				
H380	55.2	57.4	59.6					
760		58.6	60.8	63.0	64.1	65.2		
IMR-4350	58.4	60.5	62.6	64.7	65.8	66.8	67.9	
RE-19		62.8	65.0	67.2	68.3	69.4		
IMR-4831	61.8	63.6	65.4	67.2	68.1	69.0	69.9	70.8
XMR-3100	63.7	65.5	67.3	69.1	70.0	70.9		
H4831 SC	62.6	64.6	66.6	68.6	69.6	70.6		
Viht N165	62.6	65.1	67.6	70.1				
RE-22	61.3	63.3	65.3	67.3	68.3	69.3		
IMR-7828	65.4	66.9	68.4	69.9	70.7	71.4		
Magnum		71.0	73.0	75.0	76.0	77.0	78.0	
<b>Energy/ft.lbs.</b>	<b>2398</b>	<b>2561</b>	<b>2729</b>	<b>2902</b>	<b>2991</b>	<b>3081</b>	<b>3172</b>	<b>3264</b>

	Powder	Grains	Velocity	Ft. lbs.
Accuracy Load	IMR-4320	57.8	3200	2729
Hunting Load	<b>H4831 SC</b>	<b>70.6</b>	3400	3081



*Norman Johnson of Wisconsin is shown with his Semi-Sporterized Remington 40X target rifle. This 7mm Remington Magnum using Sierra 120 grain SPT bullets has taken over 300 red foxes and coyotes since 1960.*

**INDICATES MAXIMUM LOAD – USE CAUTION**  
**LOADS LESS THAN MINIMUM CHARGES SHOWN ARE NOT RECOMMENDED.**

# 7mm Remington Magnum continued

**#1903 .284" 130 gr. HPBT MatchKing**  
C.O.A.L. 3.215"



Powder↓/Velocity→	2900	3000	3100	3200	3300	3400
H4895	50.7	52.7	54.7	56.7		
IMR-4895	49.9	52.2	54.5	56.8		
IMR-4064	50.2	52.5	54.8	57.1		
XMR-4350	57.8	59.9	62.0	64.1		
IMR-4350	56.8	58.7	60.6	62.5	64.4	66.3
RE-19			62.8	65.0	67.2	
IMR-4831		61.4	63.3	65.2	67.1	
XMR-3100		63.7	65.4	67.1	68.8	
H4831 SC		62.3	64.3	66.3	68.3	70.3
MagPro			67.4	70.4	73.4	
Viht N165		62.7	65.4	68.1	70.8	
RE-22			63.3	65.3	67.3	69.3
IMR-7828			66.6	67.9	69.2	70.5
Magnum		70.5	72.0	73.5	75.0	
Retumbo			71.8	73.6	75.4	
<b>Energy/ft.lbs.</b>	<b>2428</b>	<b>2598</b>	<b>2774</b>	<b>2956</b>	<b>3144</b>	<b>3337</b>

	Powder	Grains	Velocity	Ft. lbs.
Accuracy Load	IMR-4064	57.1	3200	2956

*Sierra does not recommend MatchKing bullets for hunting applications.*

**INDICATES MAXIMUM LOAD – USE CAUTION**  
**LOADS LESS THAN MINIMUM CHARGES SHOWN ARE NOT RECOMMENDED.**

# 7mm Remington Magnum continued

**#1905 .284" 140 gr. SBT**  
C.O.A.L. 3.240"



**#1910 .284" 140 gr. SPT**  
C.O.A.L. 3.240"



Powder↓/Velocity→	2800	2900	3000	3100	3200
IMR-4895	48.0	50.4	52.8	55.2	
IMR-4064	48.0	50.5	53.0	55.5	58.0
IMR-4320	49.3	52.0	54.7	57.4	
760		55.0	57.5	60.0	
IMR-4350	53.4	55.9	58.4	60.9	63.4
RE-19			60.0	62.3	64.6
IMR-4831	54.6	57.2	59.8	62.4	65.0
XMR-3100		59.8	62.2	64.6	67.0
H4831 SC			60.6	63.0	65.4
MagPro			66.2	69.1	72.0
Viht N165			63.2	65.2	67.2
RE-22				63.0	66.0
IMR-7828			62.9	65.2	67.5
Magnum			68.6	71.5	74.4
Retumbo			69.9	71.6	73.3
<b>Energy/ft.lbs.</b>	<b>2437</b>	<b>2615</b>	<b>2798</b>	<b>2988</b>	<b>3184</b>

	Powder	Grains	Velocity	Ft. lbs.
Accuracy Load	Retumbo	71.6	3100	2988
Hunting Load	<b>IMR-4831</b>	<b>65.0</b>	3200	3184



*David Dumas of Georgia recovered this 7mm 150 grain SBT GameKing from a doe harvested in Kentucky in 2001. His load was 65.0 grains of H4831 SC and a Federal 215 primer producing a velocity of 3048 fps.*

**INDICATES MAXIMUM LOAD – USE CAUTION**  
**LOADS LESS THAN MINIMUM CHARGES SHOWN ARE NOT RECOMMENDED.**

# 7mm Remington Magnum continued

**#1913 .284" 150 gr. SBT**  
C.O.A.L. 3.240"



**#1915 .284" 150 gr. HPBT MatchKing**  
C.O.A.L. 3.240"



Powder↓/Velocity→	2700	2800	2900	3000	3100
IMR-4895	47.0	49.4	51.8		
IMR-4064	47.0	49.7	52.4		
IMR-4320	48.0	51.0	54.0		
760			56.0	58.6	
IMR-4350	52.8	55.1	57.4	59.7	62.0
RE-19			58.6	60.7	62.8
IMR-4831		56.1	59.0	61.9	
XMR-3100		59.5	61.7	63.9	
H4831 SC		57.2	60.2	63.2	
MagPro		62.5	65.0	67.5	70.0
Viht N165			60.9	64.7	
RE-22				62.0	64.5
IMR-7828			62.3	64.5	
Retumbo			67.9	69.7	71.5
<b>Energy/ft.lbs.</b>	<b>2428</b>	<b>2611</b>	<b>2801</b>	<b>2998</b>	<b>3201</b>

	Powder	Grains	Velocity	Ft. lbs.
Accuracy Load	Retumbo	69.7	3000	2998
Hunting Load	RE-22	64.5	3100	3201

*Sierra does not recommend MatchKing bullets for hunting applications.*



*John Hutto of Terrell, TX, used a 150 grain SBT GameKing to take his 300 lb. Kansas whitetail. His load was 63 grains of IMR-4350.*

**INDICATES MAXIMUM LOAD – USE CAUTION**  
**LOADS LESS THAN MINIMUM CHARGES SHOWN ARE NOT RECOMMENDED.**

# 7mm Remington Magnum continued

**#1920 .284" 160 gr. SBT**  
C.O.A.L. 3.245"



**#1925 .284" 160 gr. HPBT**  
C.O.A.L. 3.230"



Powder↓/Velocity→	2600	2700	2800	2900	2950	3000	3050	3100
IMR-4064	46.3	48.6	50.9	<b>53.2</b>				
IMR-4320	47.2	49.9	<b>52.6</b>					
760		52.8	55.6	<b>58.4</b>				
IMR-4350	50.1	52.7	55.3	57.9	59.2	<b>60.5</b>		
RE-19				60.1	61.3	62.4	63.6	<b>64.7</b>
IMR-4831	51.8	54.5	57.2	59.9	61.3	<b>62.6</b>		
XMR-3100		56.7	59.1	61.5	62.7	<b>63.9</b>		
H4831 SC		55.2	58.0	60.8	62.2	<b>63.6</b>		
MagPro		60.4	63.1	65.8	67.2	<b>68.5</b>		
Viht N165	53.8	56.8	59.8	<b>62.8</b>				
RE-22				60.4	61.6	62.8	64.0	<b>65.2</b>
IMR-7828				62.6	63.7	64.7	<b>65.8</b>	
H1000		60.0	63.0	66.0	67.5	<b>69.0</b>		
Magnum				68.3	69.4	70.5	71.6	<b>72.7</b>
Retumbo				67.9	68.8	69.6	70.5	<b>71.3</b>
<b>Energy/ft.lbs.</b>	<b>2402</b>	<b>2590</b>	<b>2786</b>	<b>2988</b>	<b>3092</b>	<b>3198</b>	<b>3305</b>	<b>3415</b>

	Powder	Grains	Velocity	Ft. lbs.
Accuracy Load	IMR-4064	50.9	2800	2786
Hunting Load	<b>H4831 SC</b>	<b>63.6</b>	3000	3198



*Tom Mack used a 160 grain SBT GameKing in his custom built 7mm Remington Magnum to take his 1994 caribou. Tom took a long shot and dropped the animal with a single, perfectly placed shot.*

**INDICATES MAXIMUM LOAD – USE CAUTION**  
**LOADS LESS THAN MINIMUM CHARGES SHOWN ARE NOT RECOMMENDED.**

# 7mm Remington Magnum continued

**#1930 .284" 168 gr. HPBT MatchKing**  
C.O.A.L. 3.260"



Powder↓/Velocity→	2600	2700	2800	2900	2950	3000
IMR-4064	46.6	49.6	52.6			
IMR-4320	48.7	51.2	53.7			
760	51.2	53.7	56.2	58.7		
XMR-4350	54.1	56.4	58.7			
IMR-4350	53.1	55.1	57.1	59.1	60.1	
RE-19			59.5	61.9	63.1	64.3
IMR-4831	54.7	57.2	59.7	62.2		
H4831 SC		57.5	59.9	62.3	63.5	64.7
MagPro		61.4	64.1	66.8	68.2	
Viht N165	55.9	58.8	61.7	64.6		
RE-22				62.3	63.5	64.6
IMR-7828			62.2	64.3	65.4	66.4
H1000	60.5	63.1	65.7	68.3		
Magnum			66.9	69.4	70.7	71.9
Retumbo				69.0	70.1	71.1
<b>Energy/ft.lbs.</b>	<b>2522</b>	<b>2720</b>	<b>2925</b>	<b>3138</b>	<b>3247</b>	<b>3358</b>

	Powder	Grains	Velocity	Ft. lbs.
Accuracy Load	RE-19	63.1	2950	3247

*Sierra does not recommend MatchKing bullets for hunting applications.*

**INDICATES MAXIMUM LOAD – USE CAUTION**  
**LOADS LESS THAN MINIMUM CHARGES SHOWN ARE NOT RECOMMENDED.**



# 7mm Remington Magnum continued

**#1940 .284" 175 gr. SBT**  
**C.O.A.L. 3.245"**



<b>Powder ↓/Velocity →</b>	<b>2600</b>	<b>2700</b>	<b>2800</b>	<b>2900</b>	<b>2950</b>	<b>3000</b>
IMR-4064	48.4	<b>51.2</b>				
IMR-4320	48.7	<b>51.5</b>				
XMR-4350	51.1	54.5	<b>57.9</b>			
IMR-4350		53.7	56.6	<b>59.5</b>		
RE-19			58.7	61.1	62.3	<b>63.5</b>
IMR-4831		52.3	56.6	<b>60.9</b>		
H4831 SC			57.4	61.3	<b>63.3</b>	
MagPro		60.4	63.4	<b>66.4</b>		
RE-22			58.8	<b>61.1</b>		
IMR-7828			62.8	<b>64.5</b>		
H1000		60.7	<b>63.4</b>			
<b>Energy/ft.lbs.</b>	<b>2627</b>	<b>2833</b>	<b>3047</b>	<b>3268</b>	<b>3382</b>	<b>3498</b>

	<b>Powder</b>	<b>Grains</b>	<b>Velocity</b>	<b>Ft. lbs.</b>
Accuracy Load	<b>RE-22</b>	<b>61.1</b>	2900	3268
Hunting Load	<b>IMR-4831</b>	<b>60.9</b>	2900	3268

**INDICATES MAXIMUM LOAD – USE CAUTION**

**LOADS LESS THAN MINIMUM CHARGES SHOWN ARE NOT RECOMMENDED.**